



Foothill Transit
GOING GOOD PLACES

FOOTNOTES

Volume 22 No. 11

November 2012



Silver 2 Silver is in action! We've collaborated with Metro to make your commute between El Monte Station and downtown Los Angeles easier, with lower fares, seamless service, and fewer restrictions. You can now ride for the new low fare of \$2.45. Seniors, persons with disabilities and Medicare cardholders can ride for \$1.15, without peak hour restrictions. That's right! We've done away with the peak and off-peak restrictions. Eligible discounted customers can ride the Foothill Transit Silver Streak for the new discounted fare 24/7.

Between El Monte Station and downtown Los Angeles, customers may use Metro and Foothill Transit passes interchangeably on both the Foothill Transit Silver Streak and Metro Silver Line. The Silver Streak 31-day pass can get you on the Foothill Transit Silver Streak and Metro Silver Line, between El Monte Station and downtown Los Angeles. The same goes for the Metro day pass; it can be used on the Metro Silver Line and on Foothill Transit's Silver Streak too! Customers using the Metro 7 day and 30 day passes will need to pay an upcharge of \$.95 cents on both the Foothill Transit Silver Streak and Metro Silver Line.

Local pass holders: take advantage of Silver 2 Silver by using your local 31-day passes. If you want to board the Foothill Transit Silver Streak or Metro Silver Line, you may use your Adult Local 31-Day pass and pay an upcharge of \$1.20. Also, eligible customers that use a Student Local 31-Day pass or Senior/Disabled/Medicare Local 31-Day pass can ride the Foothill Transit Silver Streak or Metro Silver Line, between El Monte Station and downtown Los Angeles, with no additional upcharges.

We're really excited about Silver 2 Silver and we think you will be too. Let us know what you think! Send us a comment at comment@foothilltransit.org or let us know what you think on Facebook ([facebook.com/foothilltransit](https://www.facebook.com/foothilltransit)) or Twitter (twitter.com/foothilltransit). Visit foothilltransit.org/silverstreak for more information on Silver 2 Silver.



Are you ready for some Foothill? Ahem - we mean Football!

College football season is here! You know, it never gets old. College football season brings of excitement here at Football Transit...oops Foothill Transit! We're ready to get you to all the UCLA home games this season, saving you from the fuss and hassle of driving and Rose Bowl parking.

This year, things are pretty much the same - Foothill Transit Rose Bowl service is totally free. Just get yourself to the corner of Fair Oaks and Walnut, look for the line of people - don't worry about that line, it moves pretty quickly - board the shuttles and you're on your way to the stadium in mere minutes.

Let us take care of the ride and avoid traffic and the high prices of gas and parking at the Rose Bowl! Hop on Line 187 and get off the bus on the corner of Fair Oaks and Walnut - it drops you off on the corner across from where you board the shuttles to the Rose Bowl.

You can also drive over to the Parson's lot at Fair Oaks and Holly and park there - parking is \$12 bucks. And our shuttles will be there waiting for you.

Shuttles start moving three hours before game time and start bringing people back at halftime. All games are on Saturday. Here is the remaining schedule:

Saturday, November 17 -- USC Trojans vs. UCLA Bruins
Saturday, November 24 -- Stanford Cardinal vs. UCLA Bruins

We'll also provide service to the Rose Bowl for the annual Rose Bowl Game on Tuesday, January 1, 2013. The season is still far from over and the Rose Bowl Game teams haven't been decided - but one thing is already set in stone - Foothill Transit will get you there!

So gather your foam fingers, jerseys, fan gear, and put on your best game face; we'll get to the game in style!

Complete game schedule information is also available at uclabruins.com. See you there!



Foothill Transit Thanksgiving Bus and Store Schedules



On Thursday, November 22nd, the following Foothill Transit lines will be running on their weekend schedules.

178, 185, 187, 195, 197, 269, 272, 274, 280, 281, 282, 284, 285, 286, 289, 291, 480, 482, 486, 488, 492, and the Silver Streak.

No other lines will be running.

All Foothill Transit Stores will be closed.

Thank you for riding Foothill Transit. Have a safe and happy holiday!

Student Discounts 101

We're Going Back to School: Time to brush up on our student discounts

Tuition? Check. Books? Check. Supplies? Check. Transportation? Have you seen gas prices lately? Ouch! Oh and those parking fees, we can't forget about that. We know how expensive these times can get, and it may be even tougher this year for college students as tuition fees continue to rise. We can help! Foothill Transit connects to all of the major campuses throughout the San Gabriel and Pomona valleys, including the Claremont Colleges, Citrus College, Azusa Pacific University, Pasadena City College, Mt. San Antonio College, Rio Hondo College, Cal Poly Pomona, and Cal State L.A.!

Student 31-day Pass – Eligible students can get our discounted 31-Day Student Local bus pass for only \$33.

How? It's as easy as 1-2-3.

1. Bring your student ID or any photo ID, along with a document stating your full-time student status at a local college.
2. Visit one of our five Transit Stores and fill out the application form.
3. Take a picture for your new TAP card and load your new pass!



Viola! It's as simple as that! You're now ready to ride Foothill Transit.

Are you a student at Rio Hondo College or Pasadena City College? Well you're in luck! We have special partnerships with the two schools that offer even greater discounts.

Go Rio - If you're a Rio Hondo student, riding Foothill Transit can be FREE! The Go Rio program offers full-time students a semester long pass to ride Foothill Transit's local service. For more information, call 562-463-7268 or visit the website at riohondo.edu/gorio.

iPass - If you're a student at Pasadena City College, the iPass for you! This low-cost public transit pass allows full-time students to ride Foothill Transit local buses and Metro buses and rails. It's \$30 for the full semester! Students can visit Students Business Services (Room B203) for more information.

School is hard – and paying for it can be too. But don't worry - we've got your back! Let us take care of the driving so you can focus on studying. It's our way of saying, good job and get that "A"! Visit foothilltransit.org/StudentEligibility to see if you are eligible.

Biking with Foothill Transit!

By combining Foothill Transit with a bike ride, you can extend your pedal-powered range much further across the San Gabriel and Pomona Valleys, and downtown Los Angeles. Every bus on our fleet is equipped with bike racks on the front, capable of safely storing two bikes. It's a very handy way to haul your bike across town for any reason and the racks are easy to use! Take a look at this handy diagram.

We allow folded bikes to be brought aboard. If you've got one, simply fold it up and enjoy the ride. Store the folded bike below your seat or on your lap; be sure to keep it out of the aisle. Folding bikes should be collapsed before boarding the bus. Flammable-fueled bikes or scooters are not allowed on the bus or bike racks.



SQUEEZE

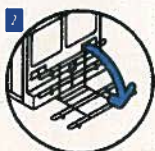

LOWER

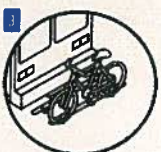

LOAD



SECURE

COMMUNITY EVENTS

Rancho Santa Ana Botanic Garden Acorn Festival

Saturday, November 17 and Sunday, November 18 from 11am to 3pm
Rancho Santa Ana Botanic Garden
1500 N. College Ave., Claremont
Celebrate the Acorn Festival with Native American dancers, singers, story tellers and tribal elders at the Garden. Activities, crafts and a native arts marketplace and cultural display booths make the Acorn Festival a fun event for visitors of all ages. This is a free event with paid Garden admission. For more information call (909) 625-8767 or visit rsabg.org/garden-events. Take Foothill Transit Line 187.

First Street Gallery Tile Show 2012

Through Friday, November 23rd; Weekdays from 9:30am to 4:30pm
First Street Gallery Art Center
250 W. First St., Suite 120, Claremont
Free art exhibit open to the public. This year's Tile Show continues to build on the traditions of community exchange and inclusion that have made the Tile Show such a unique and successful event. Take Foothill Transit Lines 187, 197, 292, or 492.

Where Electricity Met Steam

Tuesday, November 27
Pasadena History Museum
470 W. Walnut St., Pasadena
"Hop Aboard" for a talk and presentation by co-authors and co-curators, Steve Crise and Michael Patris as they delve into important aspects of the Southern California transportation system in the early 1900s. For more information call (626) 577-1660 or visit pasadenahistory.org. Take Foothill Transit Lines 187, 197, 480, or 492.

Trivia Time!

Yvette Hardin, a loyal Foothill Transit Line 187 rider, had the winning entry to last month's Silver 2 Silver Footnotes Trivia. Congrats! I think she deserves a round of applause! Who will be our next lucky winner? It could be you! This month's topic – **UCLA Bruins!**

Question:

This year's **UCLA Bruins** schedule is filled with great matchups, pairing the Bruins with great teams across the nation. Which team is the **UCLA Bruins** local rival?

- A) Stanford Cardinal
- B) USC Trojans
- C) Arizona Wildcats

[HINT: Think Southern California ;)]

As always, employees of Foothill Transit contractors and their families are not eligible to win.

Send your answers to Footnotes, c/o Foothill Transit, 100 S. Vincent Ave., Suite 200, West Covina, CA 91790. Please include your personal information, so we can let you know if you've won.

Name: _____

Address: _____

City & Zip: _____

I ride Line # _____

Daytime phone _____

Evening phone _____

FOOTNOTES

Published for the customers, board members, friends, and staff of Foothill Transit. Articles may be submitted to Hedy Satyaputra, editor.

Foothill Transit Executive Board

Patricia Wallach, Chair
Doug Tessitor, Vice Chair
Paula Lantz, Treasurer
Margaret McAustin
Carol Herrera

Doran J. Barnes
Executive Director

Foothill Transit contracts with Veolia Transportation for management and administrative services, and with First Transit for operations.



SANTA ANA
CA 926

13 NOV 2012

Foothill Transit
100 S. Vincent Ave., Ste. 200
West Covina, CA 91790

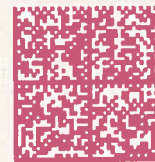

UNITED STATES POSTAGE
PITNEY BOWES
02 1A
0004318456
\$ 00.45⁰
NOV 13 2012
MAILED FROM ZIP CODE 91790

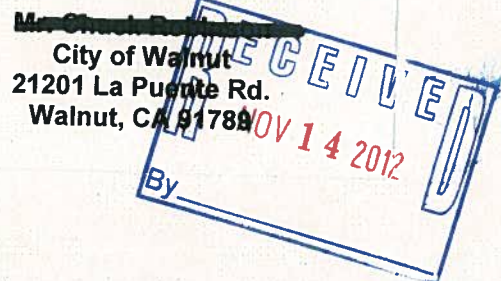

91789201801

