

HYDRAULIC ELEMENTS				
LINE	FROM	TO	QPS	PIPE SIZE
"A"	0+00	3+52	40 cfs	39"
"A"	3+52	7+18	30 cfs	24"
"A"	7+18	7+76	22 cfs	24"
"A"	7+76	7+97	14 cfs	24"
"B"	0+00	0+60	14.9 cfs	18"
"B"	0+60	0+78	8.6 cfs	18"
"B"	0+78	1+17	6.3 cfs	18"

REVIEWED	SUBMITTED	APPROVED
DATE	DIVISION ENGINEER	DATE
	HIGHWAY DIVISION	DATE
		ROAD COMMISSIONER
		DATE

LIST OF STANDARD PLANS
LOS ANGELES COUNTY ENGINEER

PIPE BEDDING D-54

LOS ANGELES COUNTY FLOOD CONTROL DISTRICT

CATCH BASIN NO. 1	2-D-160
CATCH BASIN NO. 3	2-D-163
CATCH BASIN NO. 8	2-D-289, 1, 2
MANHOLE NO. 1	2-D-102
MANHOLE FRAME & COVER FOR CATCH BASINS	2-D-156
STD. 24" MANHOLE FRAME & COVER	2-D-472
REMOVABLE PROTECTION BAR FOR CATCH BASINS	2-D-175
ADJUSTABLE PROTECTION BAR FOR CATCH BASINS	2-D-264
UNION STRUCTURE NO. 2	2-D-112
TRANSITION STRUCTURE NO. 3	2-D-188

COUNTY OF LOS ANGELES ROAD DEPARTMENT

LOCAL DEPRESSION NO. 1 68-01

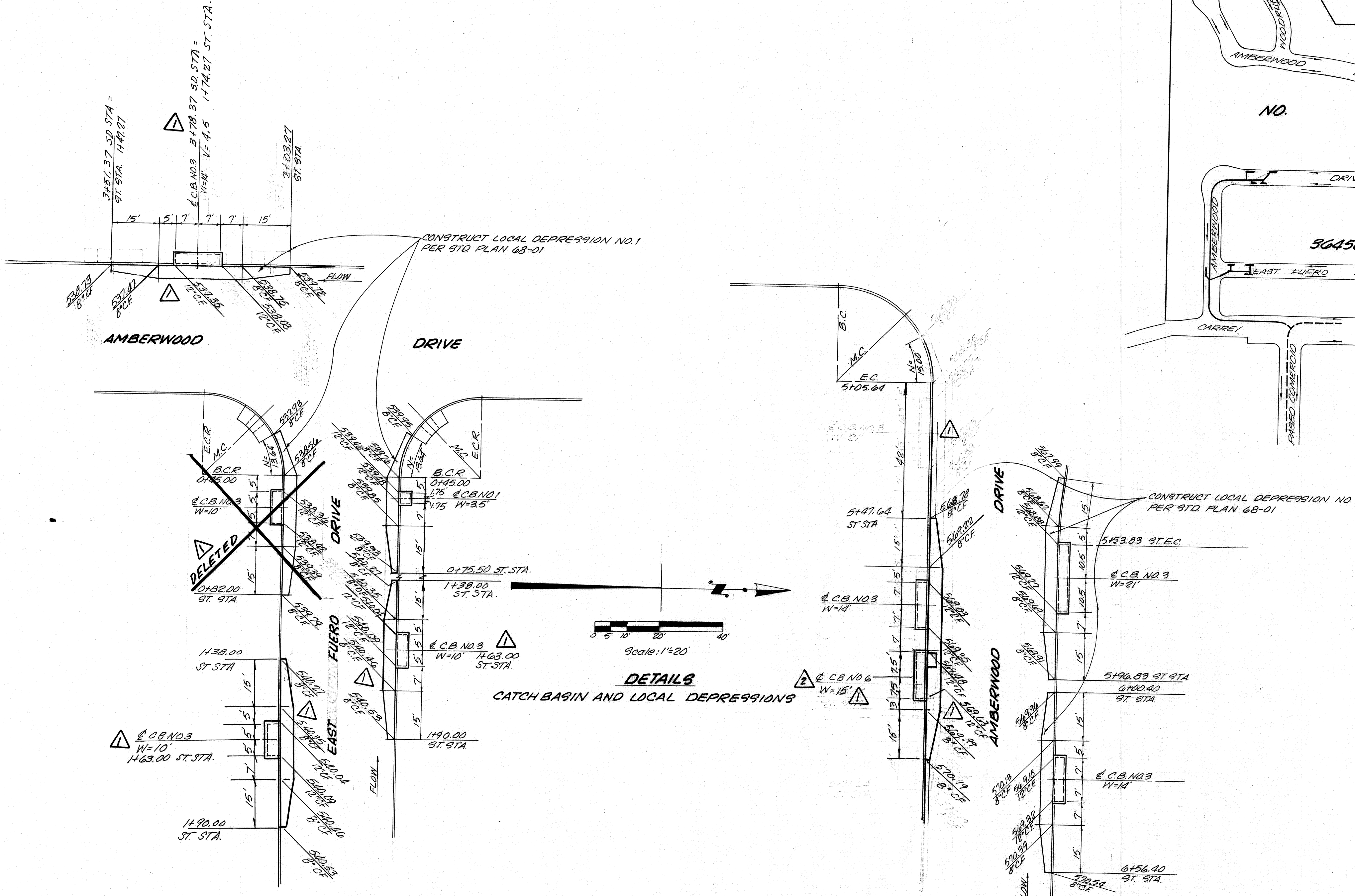
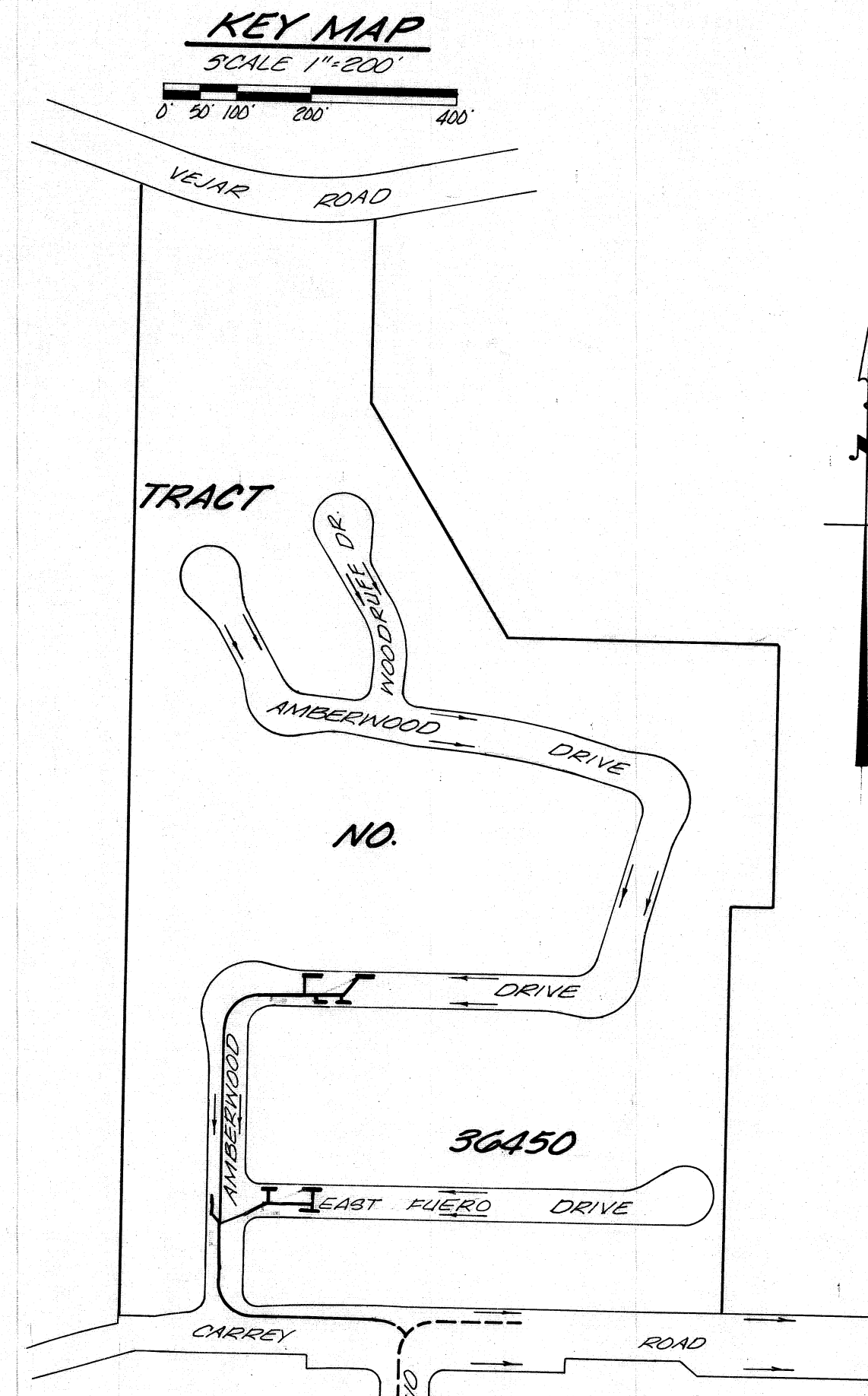

BENCH MARK:
CG 5431 ELEV. = 547.930
RD BM TAG IN CB 45 FT N/O BCR
125 FT. N. & 42 FT. W/O INT. VALLEY
BLVD. & NOGALES ST.
COVINA QUAD. 1975

- NOTES:**
- All work shall be done in accordance with "Standard Specifications for Public Works Construction" 1979 edition, with 1980 supplement, and shall be prosecuted only in the presence of the City Engineer.
 - All concrete shall be 3,000 pounds per square inch Portland cement concrete.
 - Reinforcement shall be deformed bars of intermediate grades, sizes as per A.S.T.M. A-615 grade 60.
 - All reinforced concrete pipe shall be bedded in accordance with case 4d bedding per D-54, unless otherwise specified.
 - The contractor shall notify the City Engineer by telephone (714) 226-2299 at least 24 hours before starting any work on this contract.
 - Where catch basins are located on the sidewalk, the contractor shall be responsible for the protection of the sidewalk except where the width is greater than 4 feet.
 - WHERE SIDEWALKS ARE ADJACENT TO CURB, CONSTRUCT RESIDENTIAL DRIVEWAYS PER STD. DWS. NO. 34-C.
 - THE CONTRACTOR SHALL TAKE ALL NECESSARY AND PROPER PRECAUTIONS TO PROTECT ADJACENT PROPERTIES FROM ANY AND ALL DAMAGE THAT MAY OCCUR FROM STORM WATER RUNOFF AND/OR DEPOSITION OF SEDIMENT RESULTING FROM ANY AND ALL WORK IN CONNECTION WITH SUBDIVISION CONSTRUCTION.
 - PROVIDE A STREET LIGHTING SYSTEM APPROVED BY THE LIGHTING SECTION, TRAFFIC AND LIGHTING DIVISION, AND PROVIDE FOR THE TEMPORARY OPERATION OF THE STREET LIGHTING SYSTEM.
 - AMOUNT OF BASE WILL BE DETERMINED BY SOIL TEST. SUBDIVISION ENGINEER SHALL REQUEST TEST BY ROAD DEPARTMENT AFTER STREETS HAVE BEEN ROUGH GRADED. PLAN MUST BE REVISED TO SHOW ACTUAL BASE TO BE CONSTRUCTED.
 - PROCESSED MISCELLANEOUS BASE MAY BE USED UNDER CURB AND GUTTER IN LIEU OF CRUSHED AGGREGATE BASE.
 - IN LIEU OF CRUSHED AGGREGATE BASE UNDER WALKS, CONTRACTOR MAY USE PROCESSED MISCELLANEOUS BASE OR SELECT MATERIAL WITH EXPANSION OF 1/4" OR LESS BY SOIL TEST.

CITY OF WALNUT APPROVED 7/20/01 City Engineer R.E.N.A.	PLANS PREPARED BY: JENNINGS ENGINEERING CO. 4419 VAN NUYS BLVD. SUITE 200 SHERMAN OAKS CALIF. 91403 783-1748	REVISIONS	
	SIGNATURE <i>Mark A. Silberman</i> R.E. No. 15168 CIVIL ENGINEER	RELOCATE C.B. & PROFILE GUTTER GRADE 6-1-81	REVISE 21' C.B. #3 TO 15' C.B. #6 10-15-84
	REVISION BY <i>[Signature]</i> RE. No. 20187 APPROVED <i>[Signature]</i> DATE 6-22-82	REVISION BY <i>[Signature]</i> RE. No. 20187 APPROVED <i>[Signature]</i> DATE	REVISION BY _____ RE. No. _____ APPROVED _____ DATE _____

LOS ANGELES CITY OF WALNUT DEPARTMENT

MISCELLANEOUS TRANSFER DRAIN
BENCH NO. 904
STANDARD NOTES
KEY MAP

TR. 36450

SHT 1 of 2 SHTS

